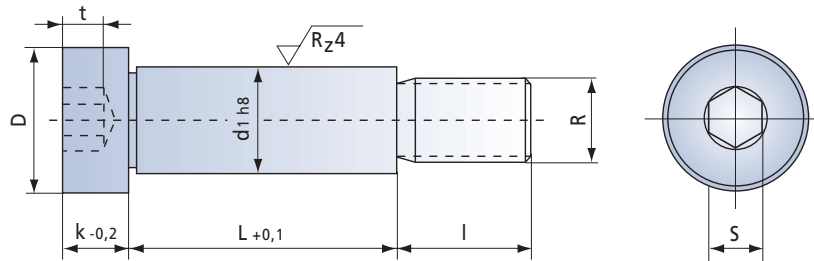

**TPM Tornillo límite macho**

$d_1$	6	8	10	12	16	20	24	32	
D	10	13	16	18	24	30	36	45	
k	5	6	7	9	11	14	16	20	
l	8	10	12	16	20	25	32	40	
s	3	4	5	6	8	10	12	17	
t	2.5	3	4	5	6	8	11	12	
R	<b>M5</b>	<b>M6</b>	<b>M8</b>	<b>M10</b>	<b>M12</b>	<b>M16</b>	<b>M20</b>	<b>M24</b>	
L	10	●							
	12	●	●						
	16	●	●	●	●				
	20	●	●	●	●	●			
	25	●	●	●	●	●			
	30	●	●	●	●	●			
	32	●	●	●	●	●	●		
	40	●	●	●	●	●	●	●	
	50	●	●	●	●	●	●	●	●
	60		●	●	●	●	●	●	●
	63		●	●	●	●	●	●	●
	70			●	●	●	●	●	●
	80			●	●	●	●	●	●
	90			●	●	●	●	●	●
	100			●	●	●	●	●	●
	110			●	●	●	●	●	●
120			●	●	●	●	●	●	
125					●	●	●	●	
160						●	●	●	
200							●	●	
250							●	●	

Material: Acero aleado especial al Cr.Mo.  
 Resistencia a la tracción: 120 - 140 Kp/mm<sup>2</sup>

Forma de pedido: TPM / R x L  
 Ejemplo: TPM / M10 x 80